

1x 184.0212 (bottle assy)

Legend of LC tubing connectors

- 250.1550 Ferrule Tefzel, 1/8", flangeless
- 250.1552 Nut PEEK, 1/8", flangeless, 1/4-28
- ▲ 250.1572 Fingertight fitting PEEK, hex, 10-32
- 250.1570 Fingertight fitting, PEEK, 10-32
- 250.1571 Fingertight Flex/Sencell, 10-32
- ⊗ 250.1574 Fingertight plug PEEK 1/16" 10-32
- ⊗ 250.1576 Fingertight plug PCTFE 1/4"-28



On the backside important installation information is provided for the parts marked with a caution sign. Please read this instructions before starting.

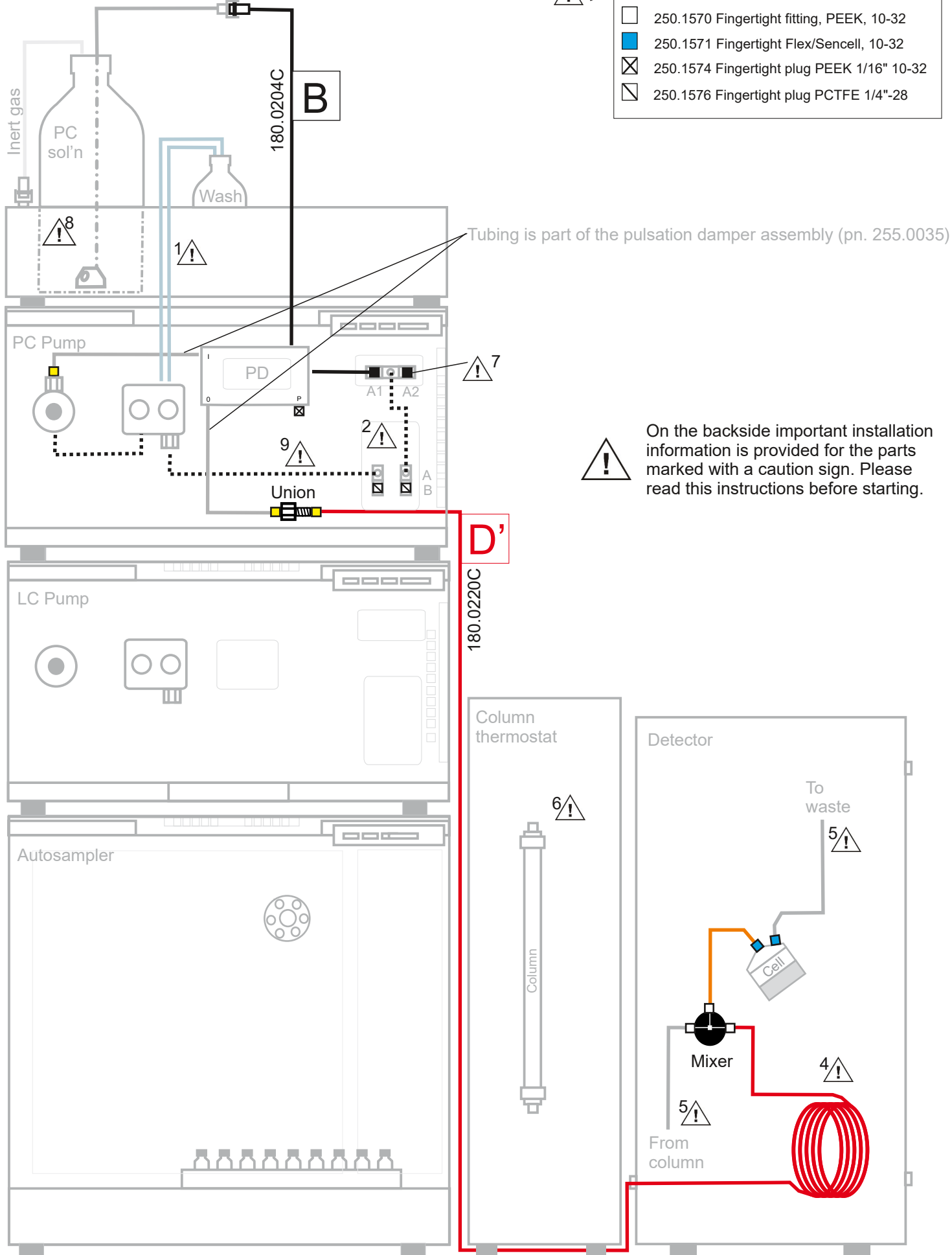



LC equipment should be used by trained laboratory personnel only. Use proper eye and skin protection when working with solvents under high pressures. Additional safety requirements or protection may be necessary depending on the chemicals used with this equipment.



IMPORTANT INSTALLATION INFORMATION

Read the LC connection kit install guide (pn. 180.7001W), before installation of the LC connection kit.

1. The piston wash tubing is not part of the LC connection kit, it can be found in the P6.1L shipkit. Read instructions in manual pn. 194.0010 how to install. Also install the supplied drainage system (funnels, hoses, nozzles) for leak management as described in the pump user manual.
2. The tubing assemblies indicated with dotted lines are already factory-installed.
3. All tubing connections in the high pressure part of the LC system are made with PEEK HEX head fingertight fittings (pn. 250.1572). Use a tightening tool (pn. 250.0094) to tighten the finger tights firmly. It will prevent that the tubing will slip out of the connector when the system is under pressure. Do not use a wrench, because with a wrench one might apply too much force resulting in rupture/damage of the plastic connector.
4. The post-column mixer assembly (pn. 180.0220C) consists of 10 meter red-striped PEEK (0.13 mm ID) as pressure restrictor to build up system pressure, a 2.2 μ L PEEK mixer and a small piece of orange-striped PEEK (0.50 mm ID) as outlet of the mixer. Make sure that the coil of red-striped PEEK is installed in the oven compartment of the detector to preheat the eluent.
5. This document describes the tubing connections for this specific post-column LC connection kit only. For installation instructions of the LC-connections of the analytical flow path please refer to the documentation provided with the LC kit of your ALEXYS carbohydrate analyzer (pn. 180.0055W or 180.0057W).
6. In case the system is not equipped with the optional column thermostat, then the analytical column should be installed in the oven of the detector.
7. Connections at the solvent selection valve (SSV): the post-column solution inlet tubing should be connected to port A1. Optionally, a bottle with DI water (flush solvent) can be connected port A2 using the degasser inlet tubing assembly (pn. 180.0204P) supplied in the LC connection kit. This option makes it possible to program a flushing method at the end of a sample sequence to clean the post-column flow path with water. A regular 2.5L HDPE bottle (pn. 180.0203C), which is not pressure resistant, can be used for the DI water as it doesn't require blanketing with inert gas.
8. Replacement filters can be ordered as '*PEEK filter for 1/8" MP inlet, 2um*' (pn. 250.1704). When replacing, push the tubing into the port that is connected to the bottom inlet until it holds.
9. The pulsation damper tubing should be connected to the union (pn. 250.1582). Then connect the outlet of the union to tubing D'.

Legend LC tubing*:

- FEP 1/8" OD, 1.59 mm ID, transparent
- Stainless Steel 1/32" OD, 0.25 mm ID, with 1/16" ends
- PEEK 1/16" OD, 0.25 mm ID, Blue-striped
- PEEK 1/16" OD, 0.13 mm ID, red-striped
- PEEK 1/16" OD, 0.064 mm ID, pink-striped
- Silicone 3 mm OD, 1 mm ID, transparent
- PEEK 1/16" OD, 0.50 mm ID, orange-striped

*) Note that the color coding of the LC tubing in the drawing does not necessarily reflect the real color of the corresponding tubing.